

SEWAGE LIFT STATION - SECTION
N.T.S.
REFER TO DRAWING D.3 FOR CONCRETE WET WELL ALTERNATE

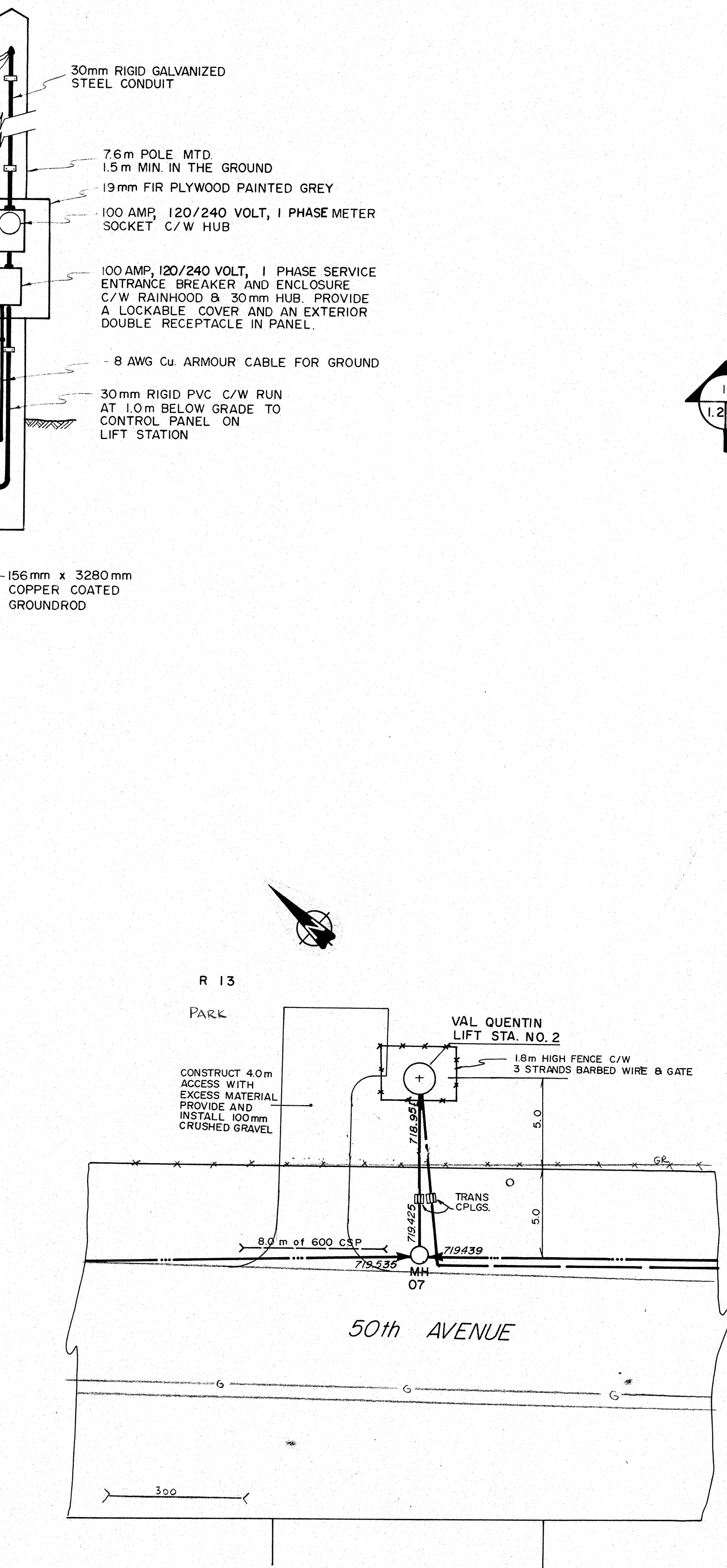

SEWAGE LIFT STATION - PLAN VIEW
N.T.S.

- EQUIPMENT SCHEDULE - VAL QUENTIN LIFT STATION NO. 2**
- 1800 DIA. CONTINUOUSLY WELDED STEEL TANK 6 MM WALL THICKNESS, SAND BLASTED, COATED FOR CORROSION PROTECTION
 - WORK PLATFORM WITH REMOVABLE SECTIONS FOR PUMP ACCESS
 - ALUMINUM HATCH COVERS WITH HINGES, LOCK DEVICES
 - M15 ANCHOR BOLTS 450 X 19
 - C150 X 22 I-BEAM - 2438 LONG (2 REQUIRED)
 - C150 X 22 I-BEAM - 880 LONG (3 REQUIRED)
 - RE-BAR MAT 15M AT 300 EACH WAY
 - 38 X 38 X 6 CHAIN FOR PUMP REMOVAL
 - 8 KG MAGNESIUM ANODES (2 REQUIRED)
 - 230V SINGLE PHASE, FLYGT MODEL 3201 (IMP 433) 3.9 HP, 230 VOLT, SINGLE PHASE, SUBMERSIBLE, SEWAGE PUMPS EACH CAPABLE OF 115 USGPM AT 30'
 - 100 MM SCHEDULE 40 STEEL PIPE AND FITTINGS
 - SLIDE RAIL SYSTEM
 - 100 MM DISCHARGE BASE ASSEMBLY
 - PROVIDE GRAB BARS ON UNDERSIDE OF HATCH LID
 - PRESSURE GAUGE C/W ISOLATION VALVE
 - MERCURY FLOAT SWITCHES
 - 100 MM GATE VALVE C/W EXTENSION STEM TO TOP OF TANK
 - 100 MM CHECK VALVE
 - COMBINATION VENTILATION FAN AND HEATER C/W DUCTING TO HIGH WATER LEVEL
 - AIR RELEASE VALVE
 - WALL MOUNTED EXPLOSION PROOF 150 WATT LIGHT FIXTURE
 - CONTROL PANEL, TANK MOUNTED
 - ROTATING LIFTING DAVIT
 - ALARM BEACON MOUNTED ON TOP OF CONTROL PANEL
 - VALVE OPERATOR EXTENSION TO TOP OF TANK. PROVIDE OPERATION WHEELS AT TOP AND NEAR VALVE.
 - EXHAUST VENT

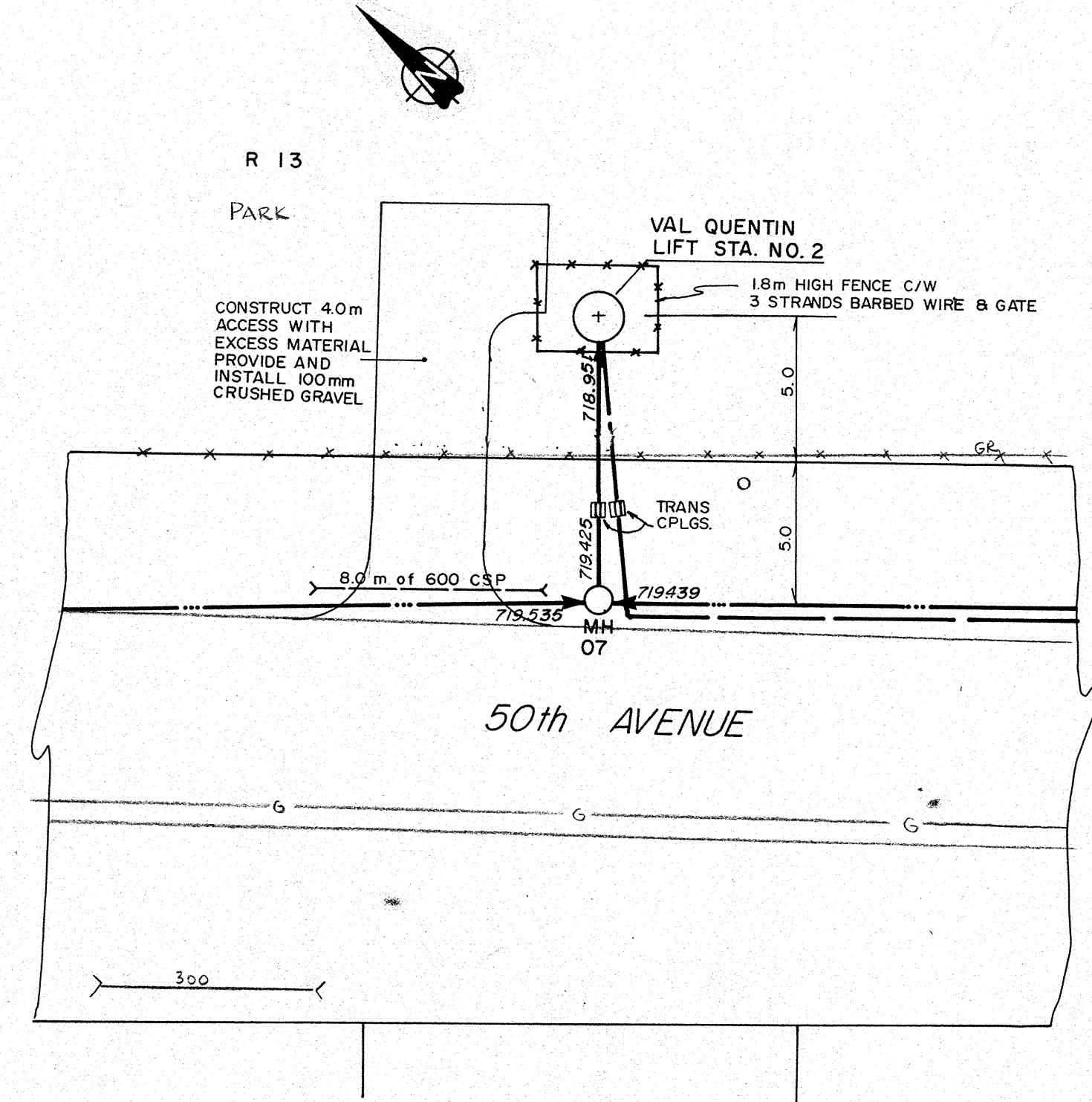

SITE PLAN
5m 0 1 2m

LEGEND

○	GRAVITY SEWER, MANHOLE, INVERT, AND DIRECTION OF FLOW
—	FORCEMAIN
□	AGT PEDESTAL
—	CSP CULVERT WIDTH
◆	FOUND LEGAL MARKER
—	POWER POLE W/ GUY
—	FENCE (WF-WIRE, CLF-CHAIN LINK, BF-BOARD, RF-RAIL, GF-GUARDFRAIL, SF-SNOW)
△	GAS REGULATOR STATION
—	POWER LINE
—	GAS LINE
—	TELEPHONE LINE
—	SERVICE CONNECTION

PERMIT TO PRACTICE
SIEMENS ENGINEERING SERVICES LTD.
Signature: *[Signature]*
Date: 9-2-90
PERMIT NUMBER: P 2998
The Association of Professional Engineers, Geologists and Geophysicists of Alberta

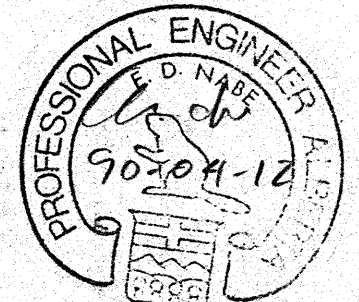

No.	DATE	DESCRIPTION	BY	APP
1	11/90	AS BUILT	DF	FM
REVISIONS				

SCALE	PROJECT No.
ASSHOWN	60-89-1
DESIGNED BY	DRAWN BY
EDN	DF
CHECKED BY	DATE
[Signature]	MAR., 1990

SIEMENS
SIEMENS ENGINEERING SERVICES LTD.
CIVIL & MUNICIPAL ENGINEERS
DEVELOPMENT CONSULTANTS • PLANNERS

TRI-VILLAGE REGIONAL SEWAGE COMMISSION	
SUMMER VILLAGE OF VAL QUENTIN SEWAGE COLLECTION SYSTEM	
LIFT STATION NO. 2 DETAILS	
SHEET	DWG. No. LS 1.2

SIEMENS
SIEMENS ENGINEERING SERVICES LTD.
AS-BUILT
DATE: 9/10/90
REVIEWED BY: *[Signature]*