

Lac Ste. Anne

51st AVE.

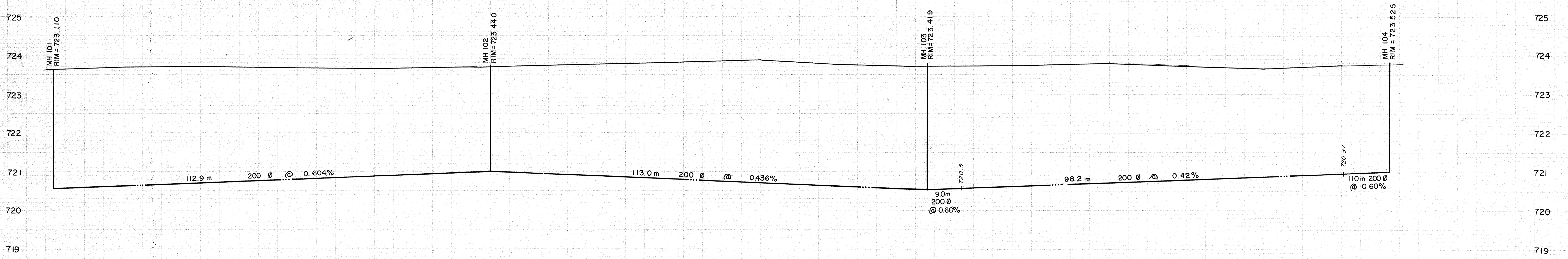
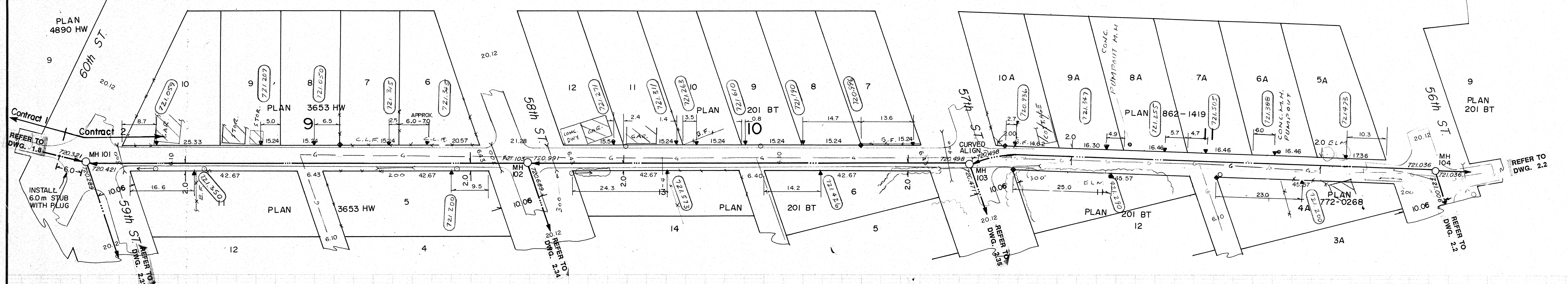

- NOTES:
1. LOCATION OF EXISTING UTILITIES ARE APPROXIMATE ONLY (A.G.T., GAS, ETC.)
 2. UTILITIES MAY EXIST WHICH ARE NOT SHOWN ON THIS DRAWING.
 3. CONTRACTOR IS RESPONSIBLE FOR GETTING UTILITY COMPANIES TO MARK OUT ALL THEIR LINES (MANS AND SERVICES).
 4. CONTRACTOR IS RESPONSIBLE FOR ANY DAMAGE TO EXISTING UTILITIES WHETHER SHOWN ON THIS DRAWING OR NOT.

SIEMENS
SIEMENS ENGINEERING SERVICES LTD.
AS-BUILT
DATE: 91-04-08
REVIEWED BY: [Signature]

- GRAVITY SEWER, MANHOLE, INVERT, AND DIRECTION OF FLOW
FORCE MAIN
EXISTING GROUND PROFILE AT CONSTRUCTION SITE
EXISTING PROPERTY LINE PROFILE, AT RIGHT
EXISTING PROPERTY LINE PROFILE, AT LEFT
EXISTING DITCH AT RIGHT OF ROAD
EXISTING DITCH AT LEFT OF ROAD
FOUND LEGAL MARKER
POWER POLE W/ GUY
GUY POLE, SERVICE OR LIGHT STANDARD POLE
HAND PUMP

- LEGEND**
TEST HOLE OR BORE HOLE
AGT PEDESTAL
CSP CULVERT WIDIA.
CONC. CULVERT WIDIA.
FENCE (WF-WIRE, CLF-CHAIN LINK, BF-BOARD, RF-RAIL, GR-GUARDRAIL, SF-SNOW)
GAS REGULATOR STATION
CATCH BASIN
POWER LINE
GAS LINE
TELEPHONE LINE
SERVICE CONNECTION

PERMIT TO PRACTICE
SIEMENS ENGINEERING SERVICES LTD.
Signature: [Signature]
Date: 91-04-12
PERMIT NUMBER: P 2998
The Association of Professional Engineers,
Geologists and Geophysicists of Alberta

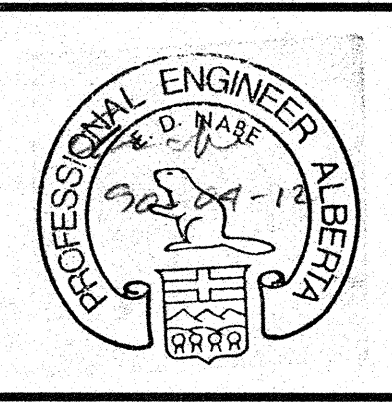

No.	DATE	DESCRIPTION	BY	APP
3	05/92	AS BUILT REVISED	DF	PM
2	11/90	AS BUILT	DF	PM
1	1990 05 23	GRADE CHANGE	DF	EN

SCALE
HORIZ. 1:100
VERT. 1:10
DESIGNED BY EDN
CHECKED BY [Signature]

PROJECT No. 60-89-1
DRAWN BY DFF YJC
DATE MAR., 1990

SIEMENS
SIEMENS ENGINEERING SERVICES LTD.
CIVIL & MUNICIPAL ENGINEERS
DEVELOPMENT CONSULTANTS • PLANNERS

TRI-VILLAGE REGIONAL SEWAGE COMMISSION
SUMMER VILLAGE OF ALBERTA BEACH
SEWAGE COLLECTION SYSTEM
51st AVENUE (LANE)
60th ST. to 56th STREET
SHEET OF DWG. No. 2.1